

CONTRACTORS SHALL VERIFY JOB DIMENSIONS BEFORE ANY JOB COMMENCES. ALL SHOP DRAWINGS SHALL BE SUBMITTED TO THE SUPERINTENDENT AND MANUFACTURER SHALL NOT COMMENCE FROM THE RETURN OF DRAWINGS SHOWN BY THE CONSULTANT. FIGURED DIMENSIONS SHALL TAKE PRECEDENCE OVER SCALES. THIS DRAWING SHALL BE READ IN CONJUNCTION WITH ALL RELEVANT CONTRACT SPECIFICATIONS AND DRAWINGS COPYRIGHT OF THIS DRAWING IS VESTED IN WARDLE.

General Notes

REFER ARCHITECTURAL DRAWINGS:

- FACADE SETOUT AR1502-AR1507
- PRECAST SETOUT AR1512-AR1517
- SCREEN SETOUT AR1502-AR1557
- SCREEN DETAILS AR6550-AR6554

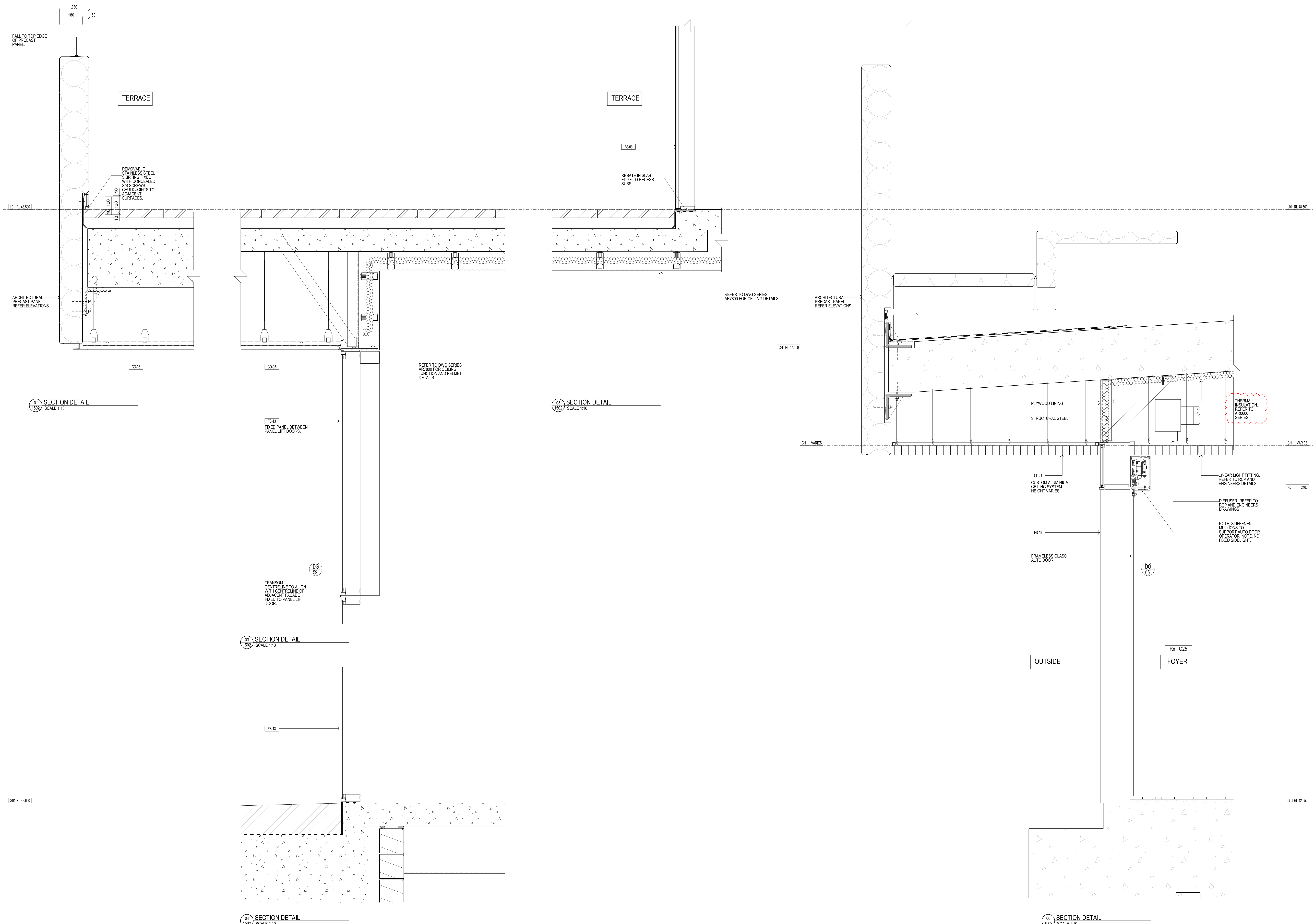

Rev	Issue	Revision Description	Amd	Date
A	SG	ISSUE FOR CONSTRUCTION	-	20.09.13
10	SG	TENDER ISSUE	-	15.04.13
09	SG	VALUE MANAGEMENT ISSUE	-	28.03.13
08	SG	PRECAST REVIEW	-	21.03.13
07	SG	100% CD - TENDER ISSUE	-	07.09.12
06	SG	90% CD ISSUE	-	10.08.12
05	SG	75% CD ISSUE	-	13.07.12
04	SG	50% CD ISSUE	-	08.06.12
03	JC	FINAL DD ISSUE	-	24.02.12
02	JC	DESIGN DEVELOPMENT ISSUE	-	20.07.12
01	JC	DESIGN DEVELOPMENT ISSUE	-	22.12.11



NADAAA
 NADAAA
 1520 Washington Street No.2 Boston Massachusetts 02118 USA
 Telephone +1 617 442 8232 Facsimile +1 688 442 1417 Email nadaaa@nadaaa.com

John Wardle Architects
 25 Rokeby Street, Collingwood, Victoria 3066 Australia
 Tel : +61 3 8662 0400 www.johnwardlearchitects.com
 © 2012 John Wardle Architects ABN 83 006 814 268

Client **University of Melbourne Parkville Campus**
 Project **Faculty of Architecture Building and Planning**

Title **SECTION DETAILS SHEET 4**

Project No.	0913	Scale	1:10 @ A0 1:20 @ A2
Drawing No.	AR6103	Revision	A

Date: Dec 2011 Drawn: Co-Ord: Chk:

FILENAME - \$FILES
FOR CONSTRUCTION